

# Vacuum Generator

# HANWHA

## ECO

Maximum vacuum flow rate: 13.8L/Min 16.8L/Min 14.5L/Min 19.2L/Min



Utility

### Product characteristics

\*Integrate various types of suction cups and modular design together. The vacuum gripping system greatly simplifies the selection and installation of vacuum systems. A more energy-efficient and reliable distributed vacuum system.



### Product structure

\*Main body: Made of plastic, small in size and light in weight

\* (1) Connector: used for compressed air intake connector

\* (2) Connection port: Vacuum connection port

\* (3) Installation screw: M3x4

\* (4) Connection port: Vacuum detection port

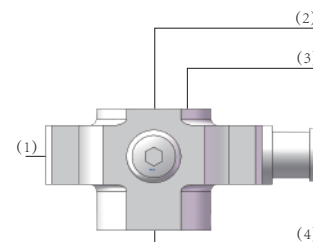

### Product advantages

\*Modular, fast and convenient installation design, vacuum system with advantages such as economic efficiency and reliable operation, can greatly simplify the selection and work of vacuum systems. Provide more convenience for customers.



\*ECO-H2010 case

## Vacuum Generator

**HANWHA**

### ECO

Maximum vacuum flow rate: 13.8L/Min 16.8L/Min 14.5L/Min 19.2L/Min



Utility



#### ECO-H2010 Ordering NO

ECO	-	H2010	-	H	-	M03
1		2		3		4

1-Series		2-Model		3- Specifications	
ECO	Vacuum Generator	H2010		H	High vacuum
				L	Low vacuum
				M	Lower in

4-Nozzle code	
03	
02	
25	
05	



#### ECO-H2010 Technical Data

Models	Use fluid	Temperature [°C]	Inlet pressure [Mpa]	Air consumption [L/Min]	Vacuum pressure reached [-KPa]	Maximum vacuum flow [L/Min]	Weight [Kg]
ECO-H2010-M	air	0~60	0.18	8.5	83	13.8	0.1
ECO-H2010-L	air	0~60	0.6	7.2	75	16.8	0.1
ECO-H2010-H	air	0~60	0.5	7.8	92	14.5	0.1

#### Vacuum flow rate (L/min) for different vacuum degrees (- kpa)

Models	0	10	20	30	40	50	60	70	80
ECO-H2010-H	13.98	9	4.74	2.64	2.16	1.8	1.38	0.78	0.42
ECO-H2010-L	21	18.6	15	10.8	6.6	4.8	3.6	1.8	0.42
ECO-H2010-M	13.8	9	3.6	2.4	2.1	1.38	0.78	0.36	0

#### Extraction time (S/L) for different vacuum degrees (- kpa)

Models	10	20	30	40	50	60	70	80
ECO-H2010-H	0.52	1.39	3.01	5.51	8.56	12.32	17.77	27.48
ECO-H2010-L	0.3	0.66	1.12	1.8	2.85	4.35	6.55	11.5
ECO-H2010-M	0.05	1.4	3.9	6.4	10	16	28	51

# Vacuum Generator ECO

**HANWHA**



Maximum vacuum flow rate: 13.8L/Min 16.8L/Min 14.5L/Min 19.2L/Min

## Performance parameter

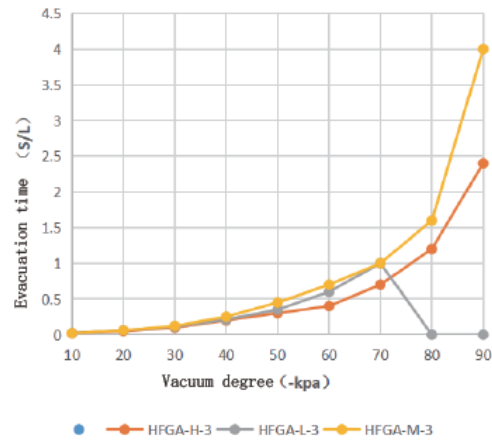
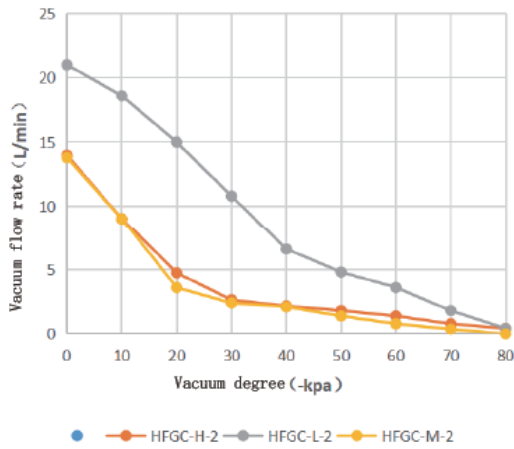

## ECO-H2010 Design Data

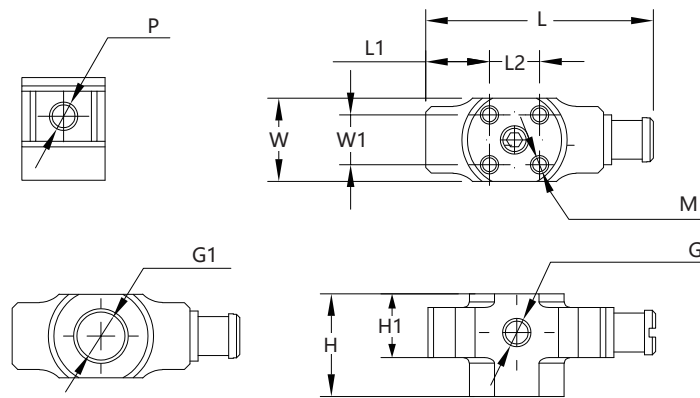

ECO-H2010

model

Size[mm]	L	L1	L2	W	W1	H	H1	P	G	G1	M
ECO-H2010-M03	41	11.5	9	15	9	18.5	11.5	M5	M5	G1/8"	4-M3 DEEP 6
ECO-H2010-L02	41	11.5	9	15	9	18.5	11.5	M5	M5	G1/8"	4-M3 DEEP 6
ECO-H2010-H25	41	11.5	9	15	9	18.5	11.5	M5	M5	G1/8"	4-M3 DEEP 6
ECO-H2010-T05	41	11.5	9	15	9	18.5	11.5	M5	M5	G1/8"	4-M3 DEEP 6