

Vacuum Generator ECO

Vacuum flow rate: 80L/Min ~ 85L/Min

HANWHA



Utility

Product characteristics

*Can integrate various types of suction cups and modular design together.

*Reduce installation costs by half, such as solenoid valves, hoses, etc

*Suitable for general end effectors, there is no need to adjust the bracket when replacing the vacuum generator



Product structure

*(1) The main body is made of aluminum profiles, with small volume and light weight

*(2) The air outlet is made of aluminum oxide

*(3) P: G1/8 2-position air intake (both sides)

*(4) V: G1/8 2-position vacuum detection (both sides)

*(5) Compressed air inlet

*(6) Vacuum connection port

*(7) V: G1/8 vacuum detection

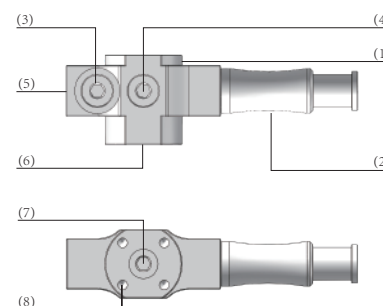

Product advantages

*Reduce energy consumption by more than 50%, and release quickly and accurately without compressed air consumption

*No maintenance required and reduces maintenance and spare parts costs

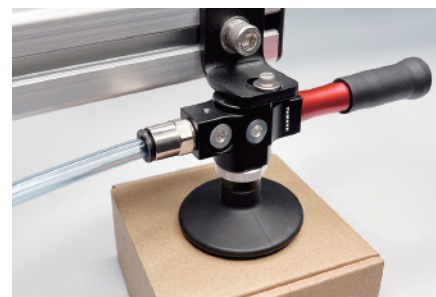

* ECO-H3010 case

Vacuum Generator

ECO

HANWHA



Vacuum flow rate: 80L/Min ~ 85L/Min

ECO-H3010 Ordering NO

ECO	-	H3010	-	FG02	-	M	-	S
1		2		3		4		5

1-Series	2-Model	3-Threaded
ECO	Vacuum Generator	H3010
		F internal thread
		G02-G1/4 G03-G3/8

4- Specifications	5-Silencer
M Low intake	S With silencer
H High vacuum	Without silencer

ECO-H3010 Technical Data

Models	Use fluid	Temperature [°C]	Intake pressure [Mpa]	Air consumption [L/Min]	Vacuum pressure reached [-Kpa]	Maximum vacuum flow [L/Min]	Weight [Kg]
ECO-H3010-FG02-M	air	0-60	0.32	26.4	90	84	0.1
ECO-H3010-FG03-M	air	0-60	0.32	26.4	90	84	0.1
ECO-H3010-FG02-H	air	0-60	0.5	26.4	75	80	0.1
ECO-H3010-FG03-H	air	0-60	0.5	26.4	75	80	0.1

Vacuum flow rate (L/min) for different vacuum degrees (- kpa)

Models	0	10	20	30	40	50	60	70	80	90
ECO-H3010-**-M-S	84	36	26.4	16.2	11.4	8.4	6	3.6	1.8	0
ECO-H3010-**-H-S	85.8	42	30	19.8	11.4	9	6.6	4.2	2.7	0.011

Extraction time (S/L) for different vacuum degrees (- kpa)

Models	10	20	30	40	50	60	70	80	90
ECO-H3010-**-M-S	0.08	0.23	0.49	1	1.7	2.6	3.9	6.3	0
ECO-H3010-**-H-S	0.09	0.26	0.5	0.9	1.5	2.2	3.4	5.2	8.8

Vacuum Generator

ECO

HANWHA

Vacuum flow rate: 80L/Min ~ 85L/Min



Performance parameter

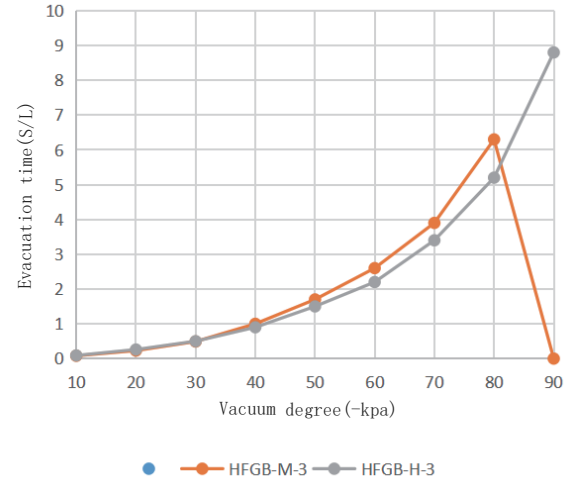
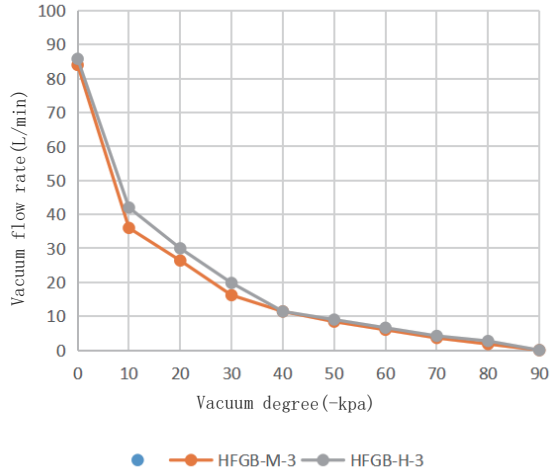

ECO-H3010 Design Data

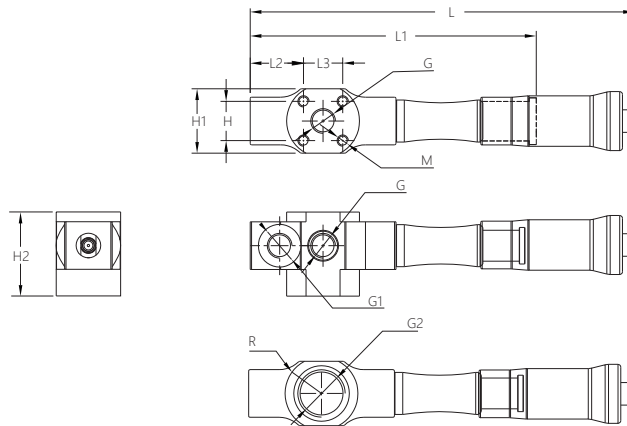

ECO-H3010

model	L	L1	L2	L3	H	H1	H2	G[V]	G1[P]	G2[V]	R	M
ECO-H3010 -FG02-M-S	136.6	98	19	14	14	23	30	G1/8	G1/8	G1/4	13	4-M4 DEEP 8
ECO-H3010 -FG03-M-S	136.6	98	19	14	14	23	30	G1/8	G1/8	G3/8	13	4-M4 DEEP 8
ECO-H3010 -FG02-H-S	136.6	98	19	14	14	23	30	G1/8	G1/8	G1/4	13	4-M4 DEEP 8
ECO-H3010 -FG03-H-S	136.6	98	19	14	14	23	30	G1/8	G1/8	G3/8	13	4-M4 DEEP 8